

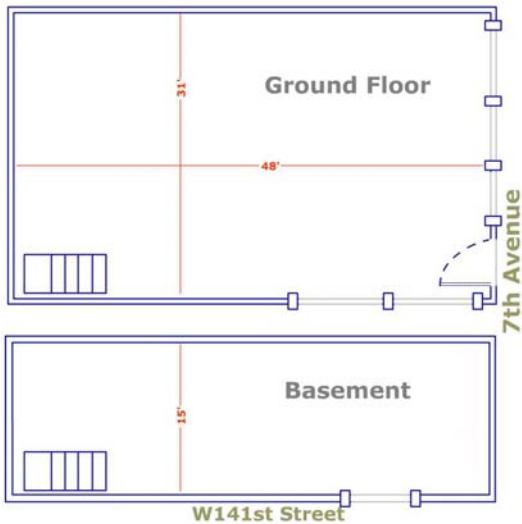

MANHATTAN RETAIL SPACE FOR RENT

≈ 2200 Square Feet on Corner of 141st and
7th Avenue New York, NY



DESCRIPTION:

Approximately 2200 Total Square Feet

Approximately 1500 Square Feet on Street Level on the
Corner of 7th Avenue and 141st Street

Approximately 725 Square Feet of Basement Space

STORE DIMENSIONS:

The store is 31' Wide X 48' Deep
Basement is 15' Wide X 48' Deep
Frontage on 7th Avenue is 31'
Frontage on 141st Street is 48'

NEIGHBORHOOD:

Space is ideal for banks, retail financial centers, restaurants, cafes, art galleries, & retail stores! The space is conveniently located at a high pedestrian traffic area. 7th Avenue is also known as Adam Clayton Powell Boulevard and is a main

neighborhood artery between Central Park North and Yankee Stadium. The space is near different modes of transportation including buses and subway. The space is blocks from the 2, 3, A, B, C, D subway stops. It is also centrally located between City College of New York, Harlem Hospital, Schomburg Center for Research, 32nd Police Precinct, and the New York Sports Club. National retailers nearby include McDonalds, Dunkin Donuts, Subway, IHOP, Quiznos, CitiBank, Starbucks, Popeye's, Chase Bank, Duane Reade, and Bank of America.



For Information Contact:

Skyline Realty LLC II

Licensed Real Estate Broker

138 Atlantic Avenue Brooklyn, NY 11201

917-498-2077 (Mobile) 718-852-7013 (Office) 718-852-6923(fax)